

# KENT

## SPECIFICATIONS

MOUNTING		TRACK
POWER	[W]	30
LAMP		built-in LED
LUMINOUS FLUX*	[lm]	3200 / 3440
LIGHT COLOUR	[K]	3000 / 4000
CRI		>90
BEAM ANGLE	[°]	26 (default)
AVERAGE LIFETIME	[h]	L80/B50.000
LUMINOUS EFFICACY	[lm/W]	106

POWER SUPPLY	[V] [A]	220-240V AC 50/60 Hz
LED-DRIVER		INCLUDED
DIMMING		PHASE DIM
THROUGH-WIRING		-

MATERIAL		ALUMINUM
INGRESS PROTECTION		IP20
PROTECTION CLASS		I
NET WEIGHT	[kg]	1,06
GROSS WEIGHT	[kg]	1,10
COLOUR (HOUSING)		WHITE ~RAL9003
COLOUR (HOUSING)		BLACK ~RAL9005

\*Luminous flux values are nominal LED data at a operating temperature of 25° C



## LIGHT DISTRIBUTION

26°

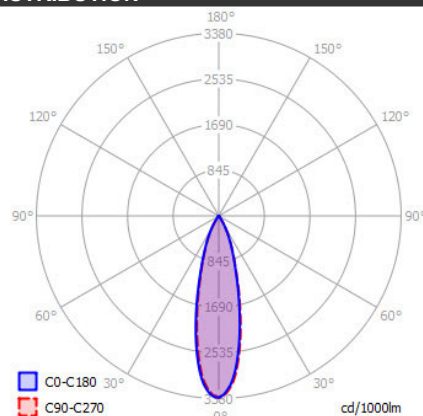

## OPTIONS / OPTIONAL ACCESSORIES

REFLECTOR	[°]	15 / 38
ANTI GLARE SHADE		BLACK
SNOOT		BLACK
HONEY COMB LOUVER		BLACK
FILTER LENS		LINEAR DIFFUSION
FILTER LENS		PRISMATIC DIFFUSION

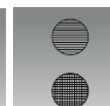
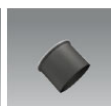
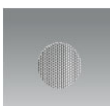

## Colours

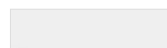

white

black

## TRACK MOUNTING

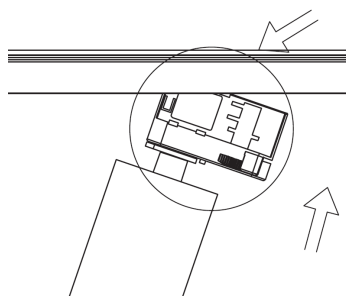

## FIXTURE DIMENSIONS

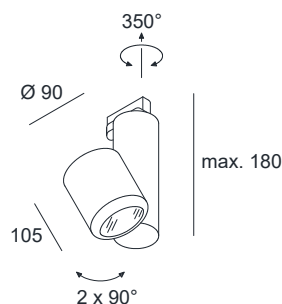

DLS LIGHTING

www.dslighting.com

**\*DLS**  
LIGHTING